

# SR-657 Aquarium Light

## Setup Guide

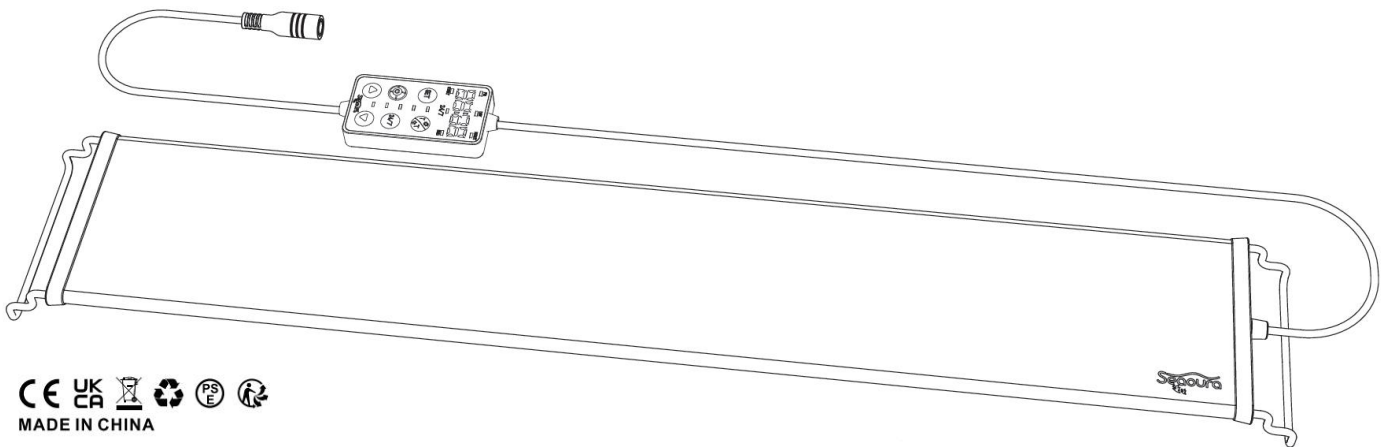

CE UK CA MADE IN CHINA



English



Español



Français



Italiano



Deutsch



Português

Website: [www.seaouraofficial.com](http://www.seaouraofficial.com)

Email: [support@seaouraofficial.com](mailto:support@seaouraofficial.com)



## Content List

|                                   |    |
|-----------------------------------|----|
| ▶ Package List.....               | 1  |
| ▶ Installation.....               | 2  |
| ▶ Working Modes Instructions..... | 4  |
| ▶ Controller Instructions.....    | 5  |
| ▶ Preset Local Time.....          | 6  |
| ▶ Regular Mode Setting.....       | 7  |
| ■ Color Setting.....              | 7  |
| ■ Brightness Setting.....         | 7  |
| ▶ Day & Night Mode Setting.....   | 7  |
| ■ Daytime Setting.....            | 7  |
| ■ Nighttime Setting.....          | 8  |
| ▶ 24/7 Mode Setting.....          | 10 |
| ■ 24/7 Schedule Instructions..... | 10 |
| ■ 24/7 Schedule Setting.....      | 10 |
| ▶ Frequently Asked Question.....  | 12 |

## ► Package List

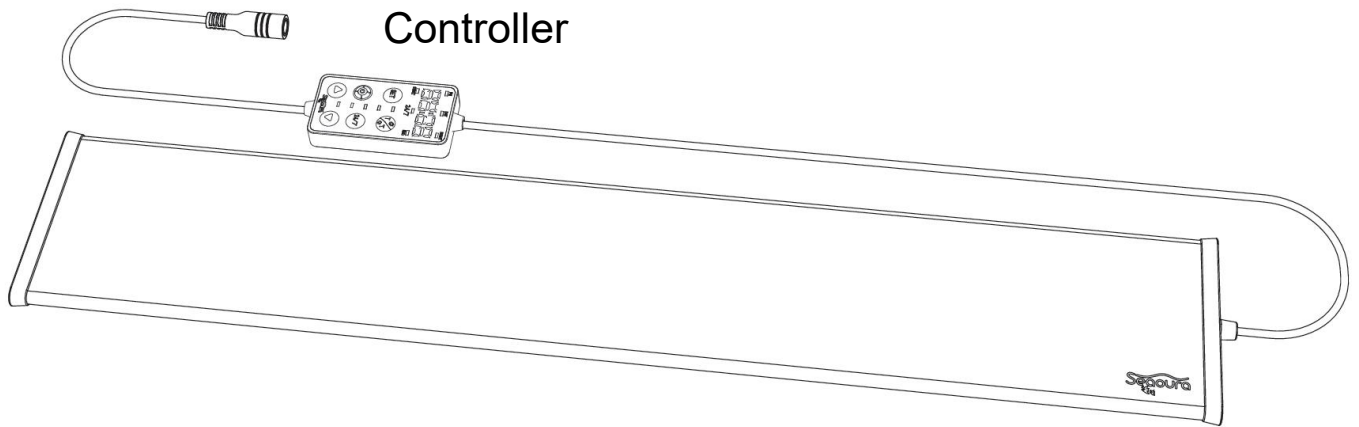

Controller

Aquarium Light

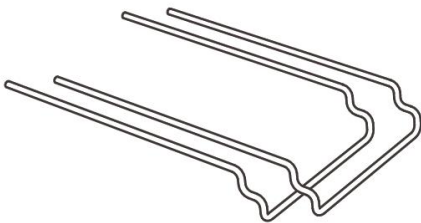

Extendable Mount

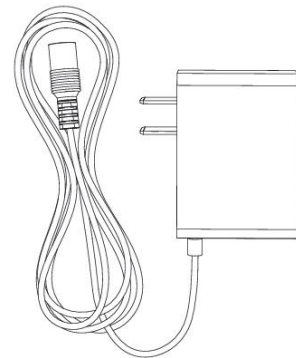

Power Adapter



Battery



User Manual

## ► Installation

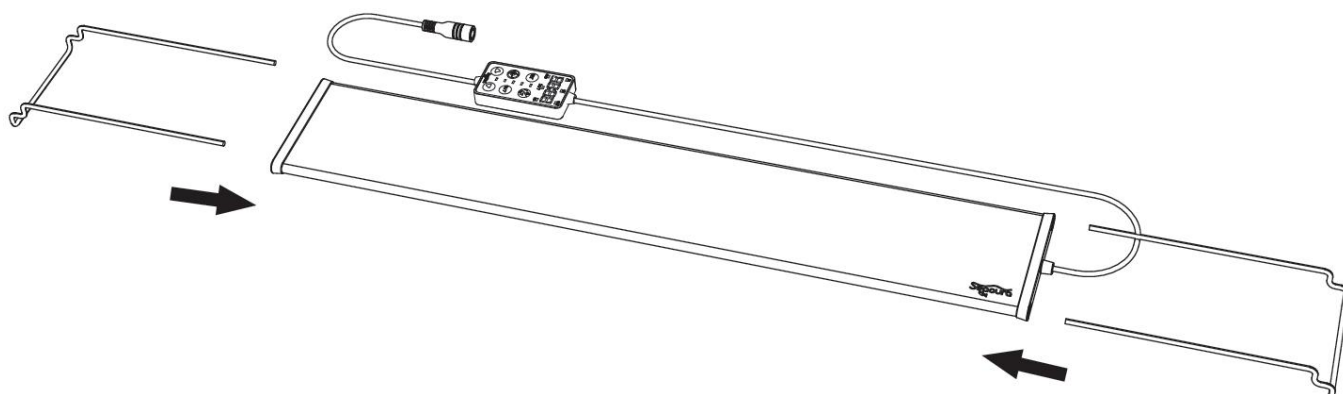

Step 1 - insert the mounts into the socket on both end of the light

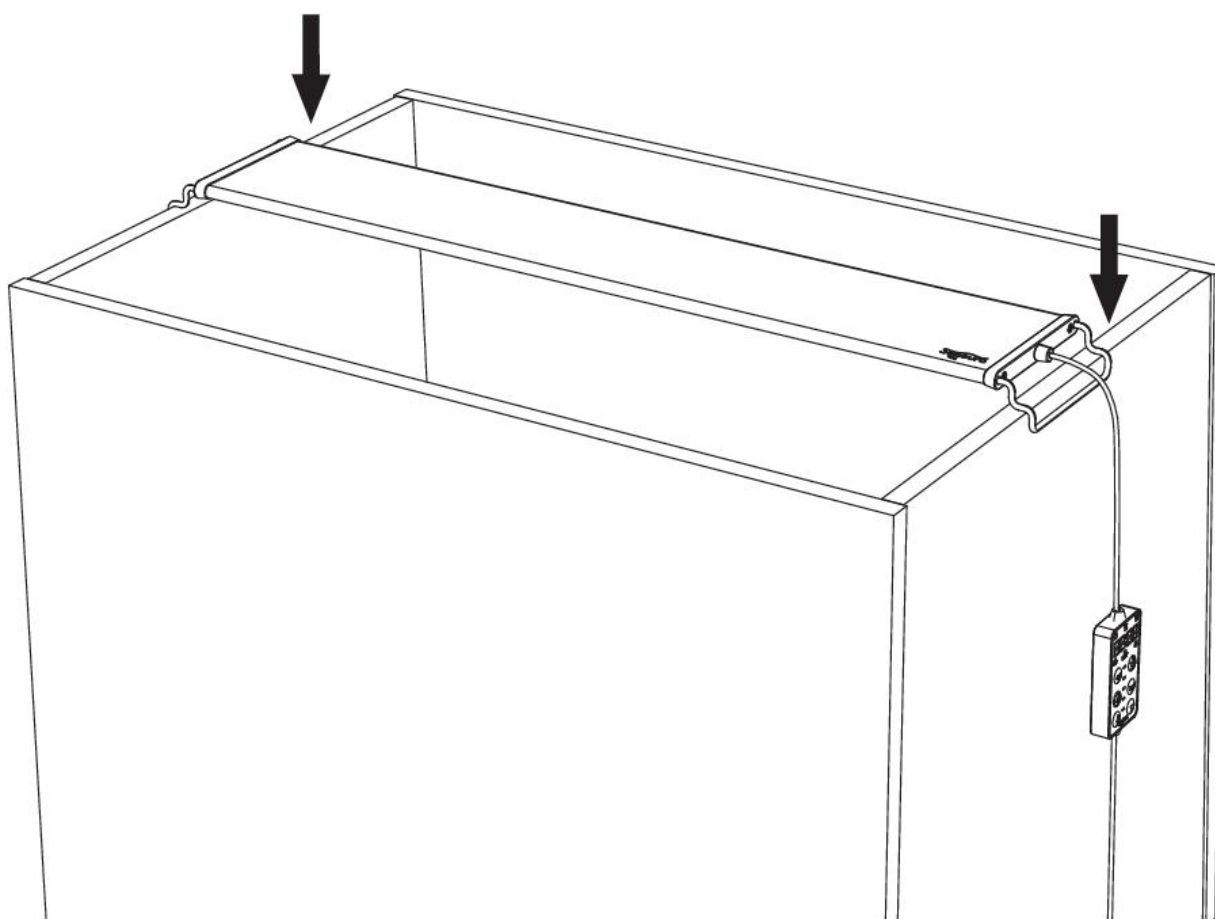

Step 2 - Adjust the length of the mount and put it on the tank

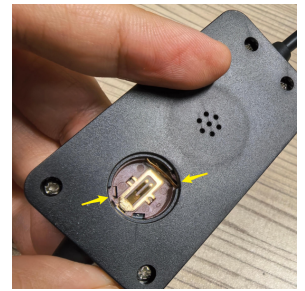
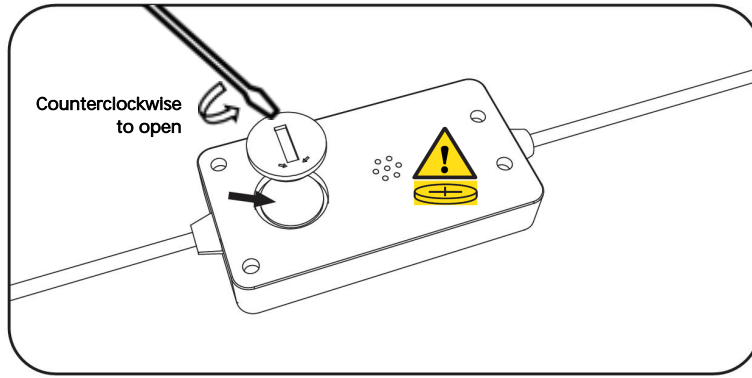

Tip: Align the groove to the notch and flip the controller to take out the cover

Step 3 - Put the battery into the controller

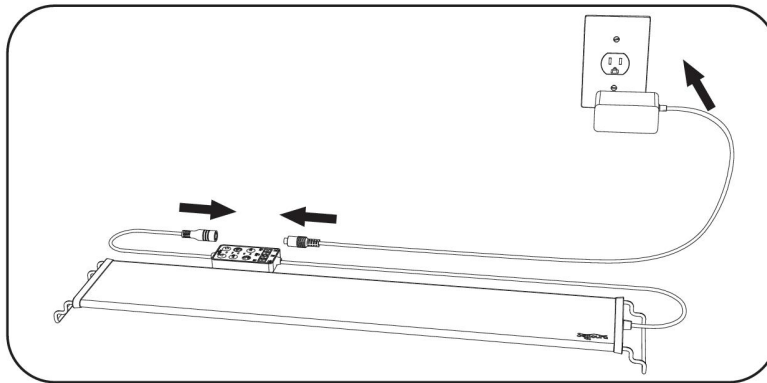

Step 4 - Connect the power supply to the light

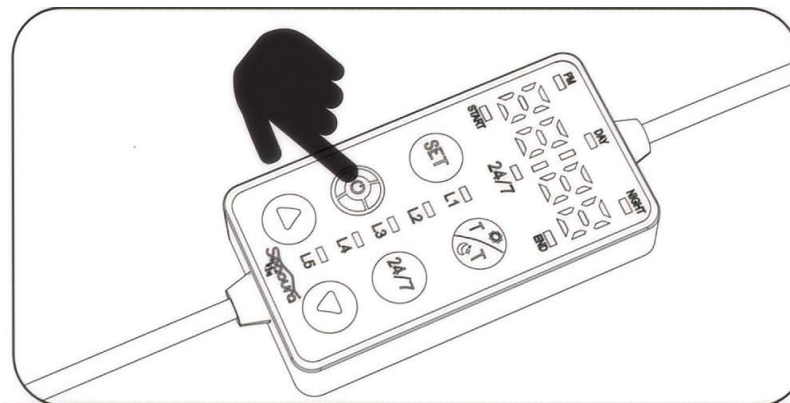

Step 5 - Press the power button to light up

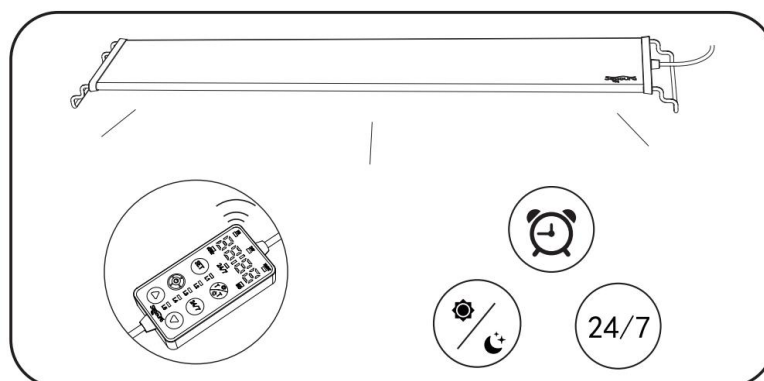

Step 6 - Set desired timer and light mode

## ► Working Modes Instructions

- **Regular Mode:** The light will remain on at the color and brightness you set.

[Go to regular mode setting guide ->](#)

- **Day & Night Mode:** The light will switch between day stage and night stage based to the two time periods you preset.

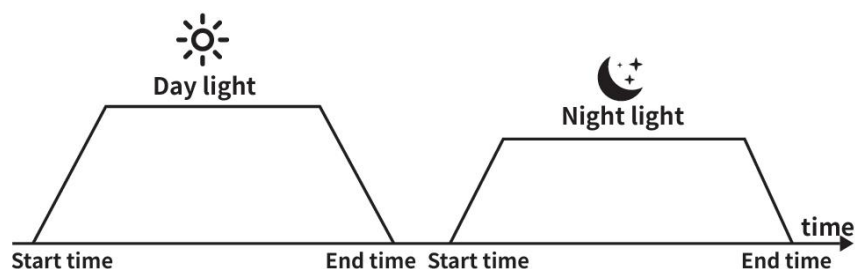

\*The brightness will gradually change to the preset level 15 minutes after the stage starts and before the stage ends.

[Go to day & night mode setting guide ->](#)

- **24/7 Mode:** The lights will run according to your preset schedule, simulating daily lighting effects, including five stages: sunrise, daytime, sunset, night and off.

- Lights and brightness are fixed into 5 stages:
- You can set the timer for the stage switching to suit your lighting schedule.

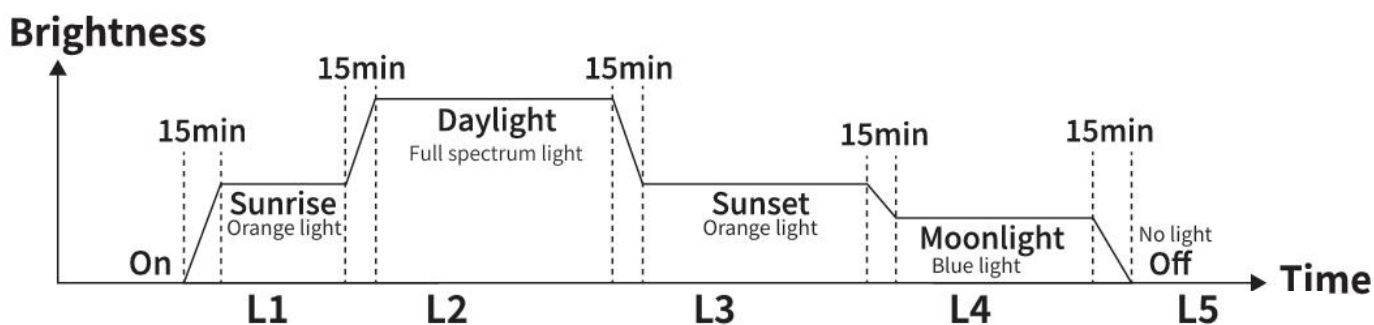

\*The brightness will gradually change to the preset level 15 minutes after the stage starts and before the stage ends.

[Go to 24/7 mode setting guide ->](#)

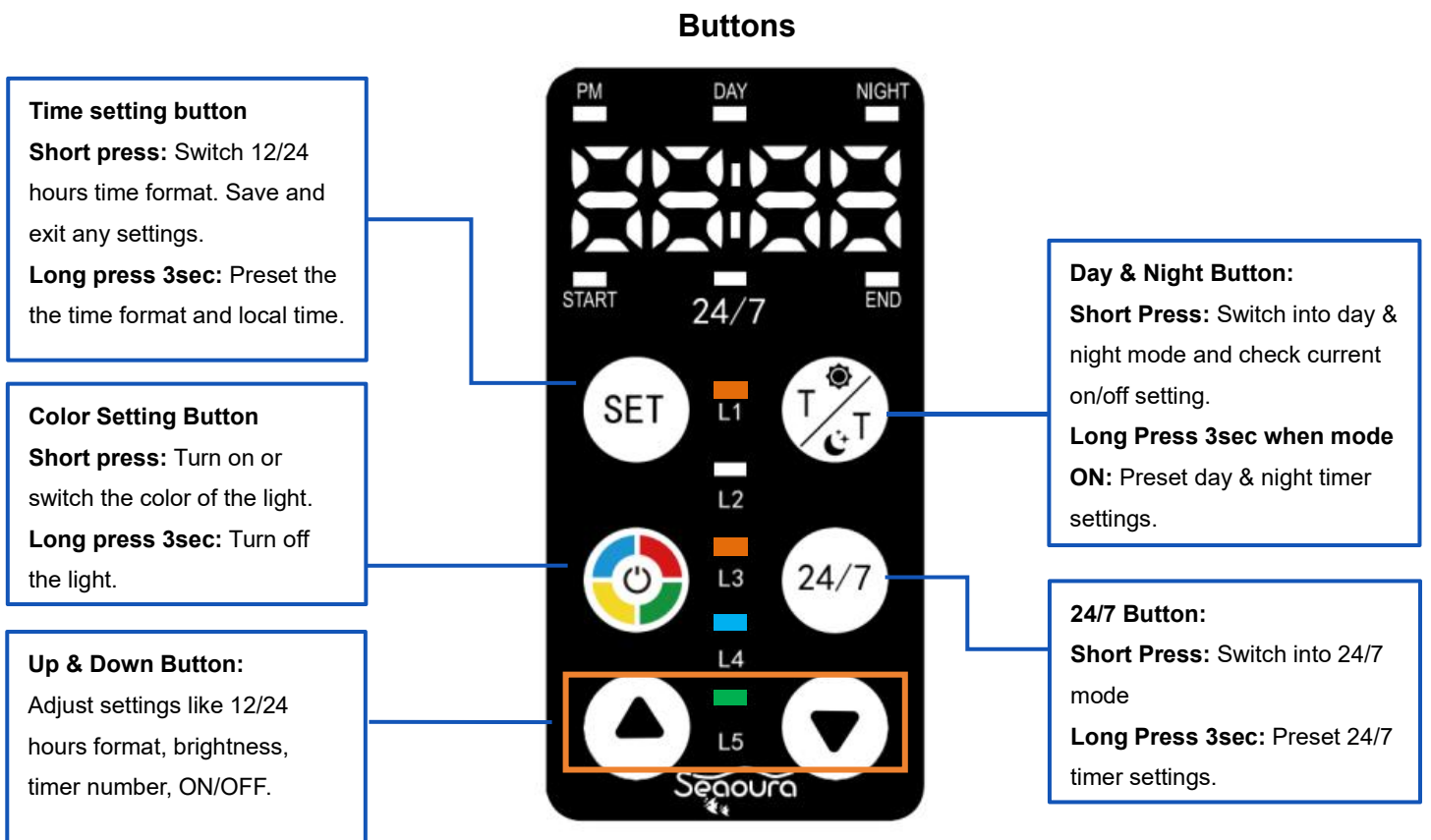
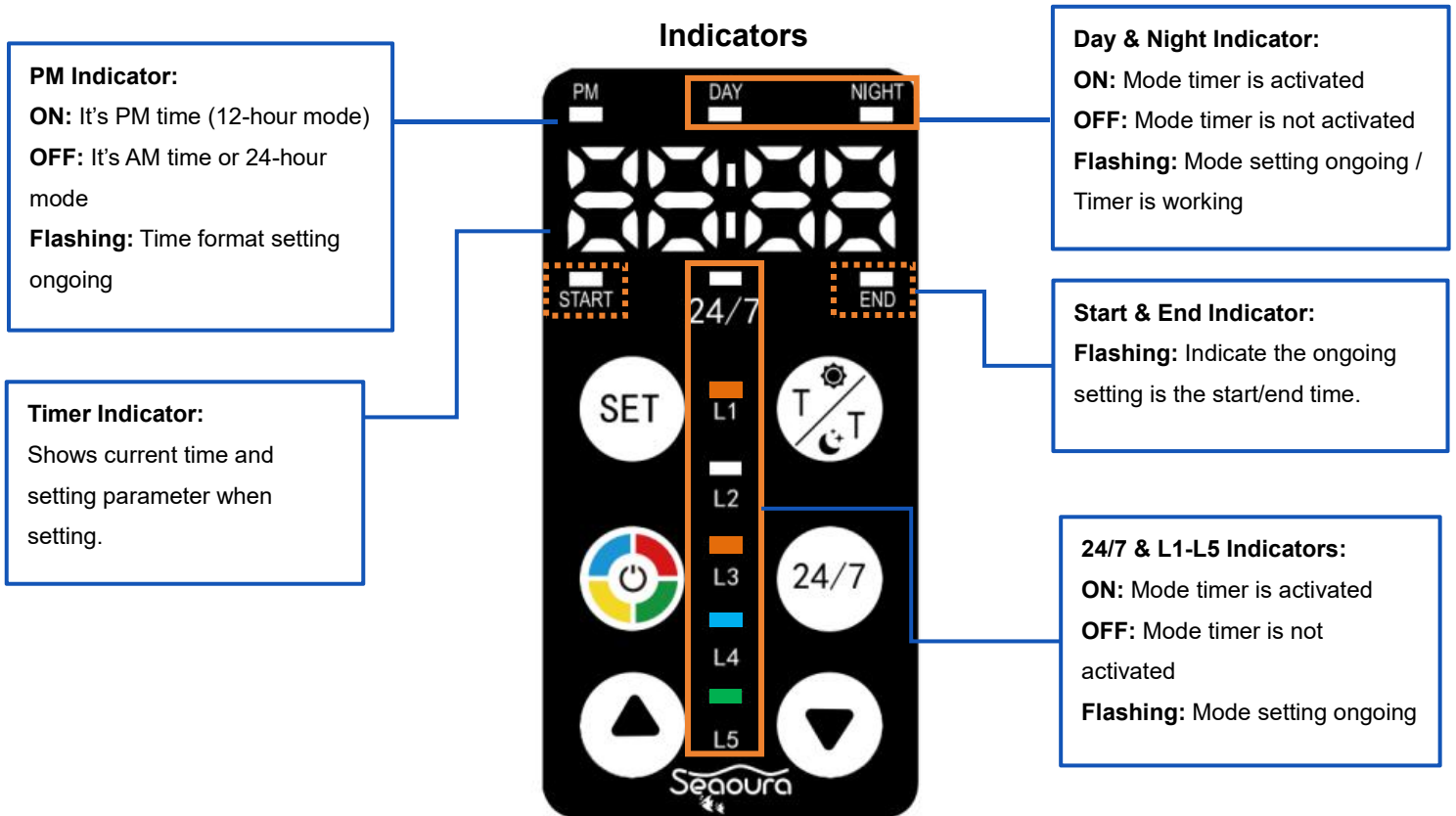

For any questions during setting timer mode, please feel free to [contact us](#).

## ► Controller Instructions







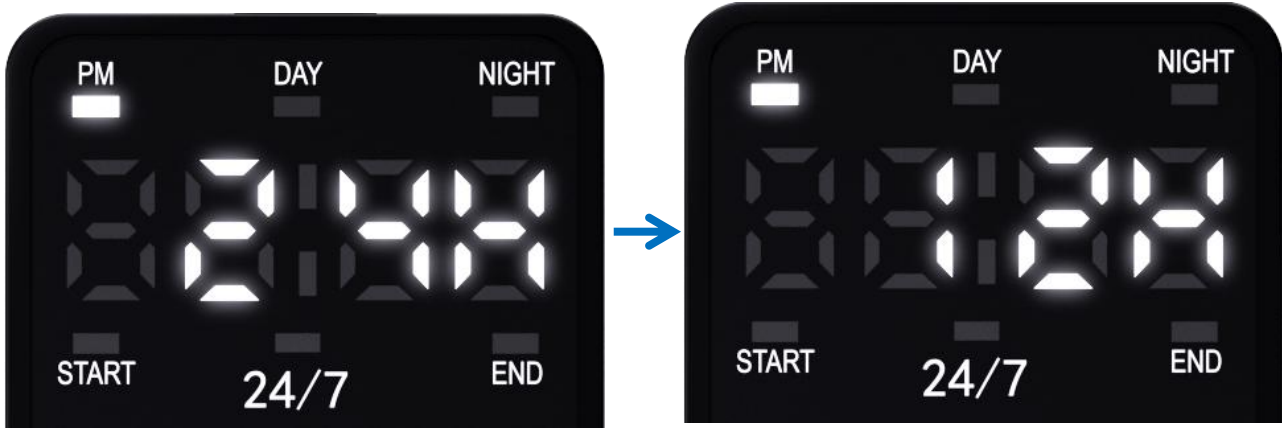

## ► Preset Local Time





1. Long press the  button for 3sec enter setting mode.
2. The PM indicator starts flashing, you can press  and  to set the time format.

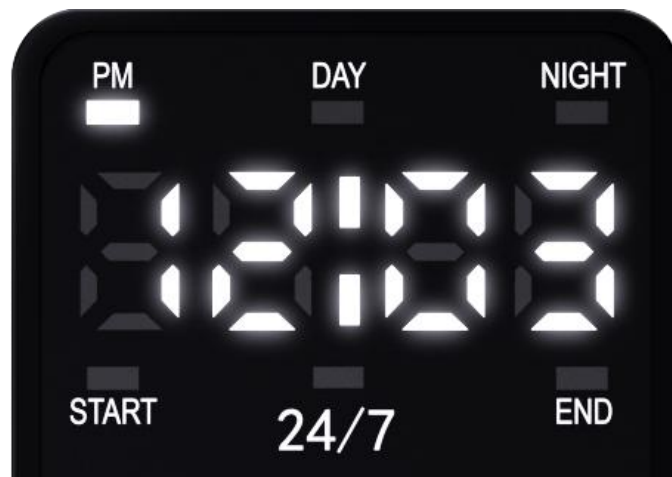

3. Short press the  button, enter local time setting, you can press  and  to set current hour.
4. Short press the  button again to enter next step, you can press  and  to set current minute.





5. Short press the  button again to finish setting.
6. Short press the  button to quick switch time format.



## ► Regular Mode Setting

### ■ Color Setting

1. Short press the  button to set color of the light.
2. Long press the  button 3sec to turn off the light.
3. Short press the  button to change regular mode back to timer mode.

➤ 9 Color Options:

| C01           | C02 | C03   | C04  | C05  | C06    | C07  | C08    | C09   |
|---------------|-----|-------|------|------|--------|------|--------|-------|
| Full Spectrum | Red | Green | Blue | Pink | Purple | Cyan | Orange | Cycle |

\*The lower the brightness setting, the faster of C09 (Cycle) color changes

### ■ Brightness Setting

1. Short press the  and  button to set the brightness.

➤ 20 Brightness Options:



| L005 | L010 | L015 | L020 | L025 | L030 | L035 | L040 | L045 | L050 | L055 | L060 | L065 | L070 | L075 | L080 | L085 | L090 | L095 | L100 |
|------|------|------|------|------|------|------|------|------|------|------|------|------|------|------|------|------|------|------|------|
| 5%   | 10%  | 15%  | 20%  | 25%  | 30%  | 35%  | 40%  | 45%  | 50%  | 55%  | 60%  | 65%  | 70%  | 75%  | 80%  | 85%  | 90%  | 95%  | 100% |

## ► Day & Night Mode Setting







\*Please [preset your local time](#) before using day & night mode for the first time.



### ■ Daytime Setting

1. Short press  button, the DAY indicator will be on, the display will shows the day mode is currently on/off. Then press  or  to change the mode into on.







2. Long press  button 3sec to enter setting mode.
3. The START indicator starts flashing, you can press  and  to set start hour. And then short press  button to set start minute.





4. Short press  button again, the END indicator starts flashing, you can press  and  to set end hour and minute like you just did in start time setting.





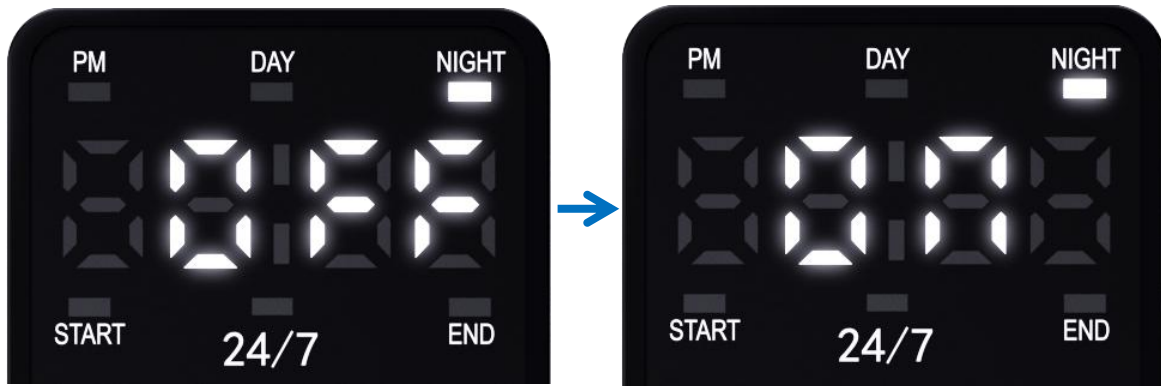

5. Short press  button again to enter brightness setting, you can press  and  to set brightness.
6. Short press  button again to finish setting.
7. When day mode is on and start working, the DAY indicator will flashing.

## ■Nighttime Setting



1. Short press  button twice, the NIGHT indicator will be on, the display will shows the night mode is currently on/off. Then press  or  to change the mode into on.







2. Long press  button 3sec to enter nighttime setting mode.

3. The START indicator starts flashing, you can press  and  to set start hour. And then short press  button to set start minute.



4. Short press  button again, the END indicator starts flashing, you can press  and  to set end



5. Short press  button again to enter color setting, you can press  to set nightlight color and then press  and  to set brightness.

6. Short press  button again to finish setting.

7. When night mode is on and start working, the NIGHT indicator will flashing.



# ▶ 24/7 Mode Setting

\*Please [preset your local time](#) before using 24/7 mode for the first time.

## ■ 24/7 Schedule Instructions

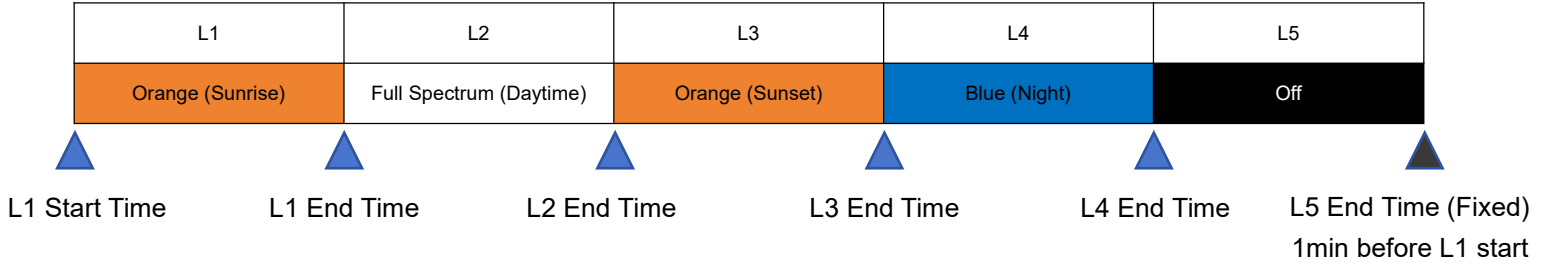

- The blue pin above indicates the time that needs to be set to form the 24/7 schedule.
- The total duration of the L1-L5 period is 24 hours, with no overlap or gaps between each stage.



## ■ 24/7 Schedule Setting

1. Long press button 3sec to enter setting mode.
2. The 24/7 indicator will be on, and the L1 and START indicator will flashing, you can press and to set L1 start hour. Then short press , and set L1 start minute.

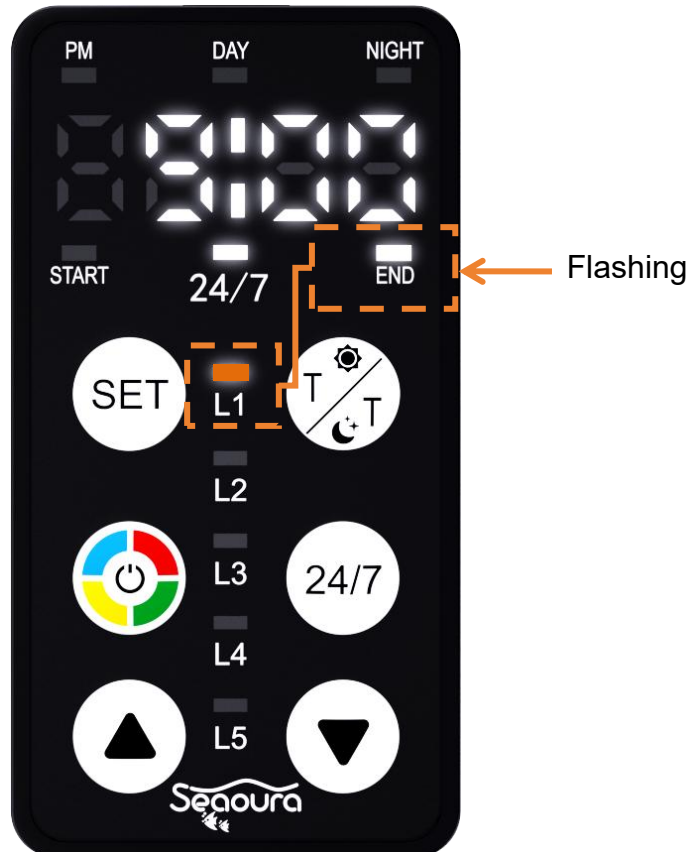

3. Short press  button to enter next step, the L1 and END indicator will flashing, you can set L1 end hour and minute like you just did in the last step.



4. Short press  button again to enter next step, the L2 and END indicator will flashing, you can set L2 end hour and minute.
5. Repeat the above steps to set L3 and L4 end time.
6. The L5 end time is fixed as 1 minute before L1 start time, you can just press  to finish setting.
7. If the mode is working, the 24/7 indicator will light up and any of the L1 to L5 indicators will light up to indicate that the timer is currently running in the corresponding phase.

For any questions during setting timer mode, please feel free to [contact us](#).

## ► Frequently Asked Question

➤ Q: Is the light waterproof?

A: Yes, the light body is made of aluminum alloy and is waterproof, but the controller is not waterproof. Please place the controller outside the water tank.

➤ Q: Do I need to reset the local time every time I disconnected the power cable?

A: If batteries are installed, the controller will have a time memory function and does not need to be set again. If the memory function does not working, please replace the battery.

➤ Q: Why does the light did not work?

A: Please check whether the wall plug is powered on normally and whether the DC power cord is connected. If it is powered on normally but still cannot work properly, please contact our after-sales email: [support@seaouraofficial.com](mailto:support@seaouraofficial.com)

➤ Q: Why does the aquarium light only light up red or flickering?

A: It may be due to insufficient voltage. Please use the original 20V power supply. If the flashing still occurs after using the included 20V power supply, please contact our after-sales email: [support@seaouraofficial.com](mailto:support@seaouraofficial.com)

➤ Q: The light temperature is a bit high, is this normal?

A: Since we use high-brightness LED chips, it is normal that the heat generated is a little bit higher than that of low-brightness LED chips.

➤ Q: Why is there some water vapor on the transparent lampshade of the aquarium light?

A: Please don't worry, because the temperature inside the lamp is relatively high, some water vapor may evaporate on the lampshade. The light body is waterproof, so it will not affect the normal function of the aquarium light.

If you have any questions when setting the timer mode, please feel free to contact us.

Email: [support@seaouraofficial.com](mailto:support@seaouraofficial.com)

WhatsApp: +1 8067018867

To get first-hand discount and product updates, please follow us:

